

Compression Connectors for Copper Conductor

One-Hole Lugs — 90° Standard Barrel 600V to 35kV

Material: High-Conductivity
Wrought Copper

Finish: Electro Tin Plate

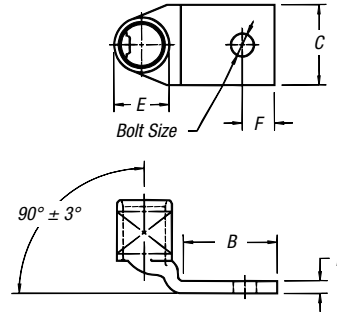

CAT. NO.	WIRE SIZE			DIMENSIONS (IN.)					DIE CODE	DIE COLOR
	CODE	FLEX CLASS G, H, I, K, M†	BOLT SIZE	B	C	D	E	F		
54104UB		23 Navy	#10	.50	.39	.08	.25	7/32	21	RED
54130UB	#8 AWG	#8 Weld	1/4	.61	.45	.07	.25	1/4	21	
54131UB		37/24 = 14.9 kcmil	5/16	.64	.56	.05	.25	9/32	21	
54132UB			3/8	.64	.56	.05	.25	9/32	21	BLUE
54134UB	#6 AWG	30 Navy	#10	.53	.44	.07	.31	7/32	24	
54105UB		#6 Weld	1/4	.53	.44	.07	.31	7/32	24	
54135UB		61/24 = 24.6 kcmil	5/16	.67	.60	.07	.31	5/16	24	GRAY
54136UB		133/.014	3/8	.67	.60	.07	.31	5/16	24	
54138UB	#4 AWG	#4 Weld	#10	.60	.55	.09	.37	1/4	29	
54106UB		40-50 Navy	1/4	.60	.55	.09	.37	1/4	29	
54139UB		91/24 = 36.7 kcmil	5/16	.66	.61	.07	.37	5/16	29	
54140UB		133/.0177	3/8	.66	.61	.07	.37	5/16	29	
256-30695-264UB		49/.029	1/2	1.40	1.00	.06	.37	1/2	29	BROWN
54107UB	#2 AWG	#5-91/24	1/4	.65	.59	.11	.41	1/4	33	
54142UB		60 Navy	5/16	.88	.59	.11	.41	3/8	33	
54143UB		125/24 = 50.4 kcmil	3/8	.80	.59	.11	.41	3/8	33	GREEN
54145UB		#3 Weld	1/2	1.08	.75	.08	.41	1/2	33	
54108UB	#1 AWG	75 Navy, #2 Weld	1/4	.65	.68	.11	.47	1/4	37	
54147UB		150/24 = 60.5 kcmil	5/16	.93	.68	.11	.47	3/8	37	
54148UB		175/24 = 70.6 kcmil	3/8	.98	.68	.11	.47	3/8	37	
54150UB		133/.0223	1/2	1.25	.76	.11	.47	1/2	37	
54152UB		100 Navy	1/4	.65	.75	.13	.52	1/4	42	PINK
54153UB	1/0 AWG	#1 Weld	5/16	.88	.75	.13	.52	3/8	42	
54109UB		225/24 = 90.8 kcmil	3/8	.93	.75	.13	.52	3/8	42	
54155UB		133/.0254	1/2	1.25	.75	.13	.52	1/2	42	BLACK
54157UB	2/0 AWG	125 Navy	1/4	.65	.83	.13	.57	1/4	45	
54158UB		1/0 Weld	5/16	.88	.83	.13	.57	3/8	45	
54110UB		275/24 = 111 kcmil	3/8	.93	.83	.13	.57	3/8	45	ORANGE
54160UB		427/.0155, 133/.0282	1/2	1.25	.83	.13	.57	1/2	45	
54162UB	3/0 AWG	150 Navy, 2/0 Weld	1/4	.65	.92	.13	.63	1/4	50	
54163UB		325/24 = 131 kcmil	5/16	.88	.92	.13	.63	3/8	50	
54111UB		133/.0316, 259/.0227	3/8	.93	.92	.13	.63	3/8	50	PURPLE
54165UB		427/.0177	1/2	1.25	.92	.13	.63	1/2	50	
54167UB	4/0 AWG	200 Navy	1/4	.65	1.03	.14	.70	1/4	54	
54168UB		3/0 Weld	5/16	.87	1.03	.14	.70	3/8	54	
54112UB		450/24 = 182 kcmil	3/8	.93	1.03	.14	.70	3/8	54	YELLOW
54170UB		703/.0154	1/2	1.25	1.03	.14	.70	1/2	54	
58161UB		4/0 Weld	1/4	.78	1.25	.15	.79	3/8	62	
58162UB		550/24 = 222 kcmil	5/16	.88	1.25	.15	.79	3/8	62	YELLOW
58163UB		133/.0399	3/8	.93	1.25	.15	.79	3/8	62	
58165UB		259/.0286	1/2	1.25	1.25	.15	.79	1/2	62	
58166UB		637/.0183	3/8	1.58	1.25	.15	.79	5/8	62	

† Contact Technical Services for specific stranding listings

Tooling: pp. F-80-F-100 Die Selector Chart: pp. F-101-F-104

Compression Connectors for Copper Conductor

One-Hole Lugs — 90° Standard Barrel 600V to 35kV (continued)

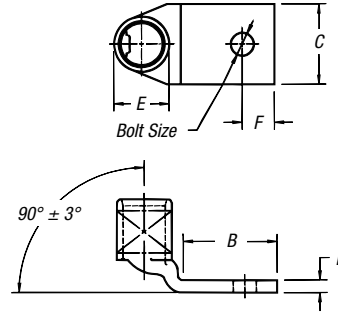

Material: High-Conductivity Wrought Copper

Finish: Electro Tin Plate



CAT. NO.	WIRE SIZE		BOLT SIZE	DIMENSIONS (IN.)					DIE CODE	DIE COLOR
	CODE	FLEX CLASS G, H, I, K, M†		B	C	D	E	F		
54172UB			¼	.65	1.13	.14	.77	¼	62	YELLOW
54173UB	250 kcmil	250 Navy	⅝	.88	1.13	.14	.77	⅜	62	
54174UB			¾	.93	1.13	.14	.77	⅝	62	
54113UB			½	1.25	1.13	.14	.77	½	62	
58168UB		250 Weld, 650/24 = 262 kcmil, 259/.0311, 703/.0189	½	1.25	1.25	.15	.85	½	66	WHITE
54178UB			⅝	.88	1.25	.15	.85	⅜	66	
54179UB	300 kcmil	300 Navy	¾	.93	1.25	.15	.85	⅜	66	
54114UB			½	1.25	1.25	.15	.85	½	66	
54181UB			¾	1.58	1.25	.15	.85	⅝	66	
58171UB		300 Weld, 259/.034, 427/.0265, 889/.0183 775/24 = 313 kcmil	½	1.25	1.36	.18	.93	½	71	RED
256-30695-112UB			¾	1.25	1.36	.18	.93	½	71	
54115UB	350 kcmil	350 Navy	½	1.25	1.36	.18	.93	½	71	
54183UB			¾	1.58	1.36	.18	.93	⅝	71	BLUE
58174UB		350 Weld, 259/.0368, 427/.0285, 703/.0224, 889/.0201	½	1.25	1.61	.22	1.09	½	76	
54116UB	400 kcmil	400 Navy	½	1.25	1.41	.17	.96	½	76	
54185UB			¾	1.58	1.41	.17	.96	⅝	76	
256-30695-1403UB		400 Weld, 925/24 = 373 kcmil	¾	1.31	1.61	.22	1.04	¾	80	N/A
58177UB		259/.0393, 427/.0306	½	1.25	1.61	.22	1.04	½	80	
54118UB	500 kcmil	500 Navy	½	1.25	1.61	.22	1.10	½	87	BROWN
54187UB			¾	1.58	1.61	.22	1.10	⅝	87	
58180UB		1100/24 = 444 kcmil, 450, 1127 450, 4522	¾	1.58	1.75	.24	1.20	¾	94	GREEN
54120UB	600 kcmil		¾	1.58	1.75	.24	1.20	¾	94	
54122UB	700 kcmil		¾	1.58	1.84	.23	1.26	¾	99	PINK
256-30695-840UB		1325/24 = 535 kcmil	½	1.69	1.81	.28	1.25	⅞	99	
58182UB		500 Flex, 427/.0342, 259, 1125, 5054	¾	1.58	1.81	.28	1.25	¾	99	
54123UB	750 kcmil	600 Flex 427	¾	1.58	1.94	.27	1.33	¾	106	BLACK
58184UB		1600/24 = 646 kcmil	¾	1.58	1.94	.27	1.33	¾	106	
54124UB	800 kcmil	800 Navy	¾	1.58	2.01	.27	1.38	¾	107	ORANGE
54126UB	900 kcmil	1925/24 = 777 kcmil, 900 Navy	¾	1.58	2.17	.31	1.50	¾	115	YELLOW
54128UB	1000 kcmil	1000 Navy	¾	1.58	2.27	.30	1.55	¾	125	N/A

† Contact Technical Services for specific stranding listings

Tooling: pp. F-80-F-100

Die Selector Chart: pp. F-101-F-104